

## Mounting Options LDNF320 & LDNF330 Series

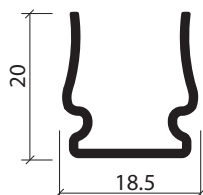

**Product code:** **LDNF320SMC-5CM**

Stainless steel mounting clip for  
LDNF320TVF, 321, 323, 324, 325, 326, 327, 328, 329 (topview flat emitting face 120deg)  
LDNF331TVF (sideview flat emitting face 120deg)  
50mm in length with two screw holes

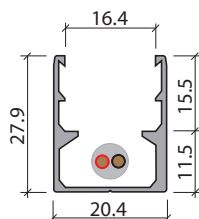

**Product code:** **LDNF320H01-2M**

Standard profile with cable cavity for  
LDNF320TVF, 321, 323, 324, 325, 326, 327, 328, 329 (topview flat emitting face 120deg)  
LDNF331TVF (sideview flat emitting face 120deg)  
Silver anodised aluminium in 2m lengths

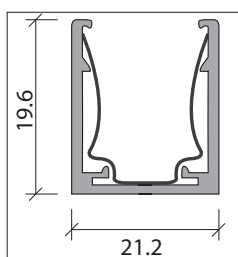

**Product code:** **LDNF320S03-2M**

Anti drop profile used when neon flex is facing down for  
LDNF320TVF, 321, 323, 324, 325, 326, 327, 328, 329 (topview flat emitting face 120deg)  
LDNF331TVF (sideview flat emitting face 120deg)  
Silver anodised aluminium in 2m lengths with stainless steel insert

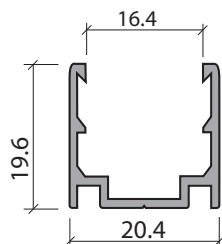

**Product code:** **LDNF320S02-2M**

Surface mount profile with screw fastening flange for  
LDNF320TVF, 321, 323, 324, 325, 326, 327, 328, 329 (topview flat emitting face 120deg)  
LDNF331TVF (sideview flat emitting face 120deg)  
Silver anodised aluminium in 2m lengths

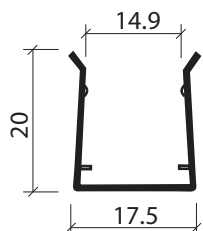

**Product code:** **LDNF320FLX-10CM, LDNF320FLX-30CM, LDNF320FLX-50CM, LDNF320FLX-1M**

Segmented profile to give bend support for  
LDNF320TVF, 321, 323, 324, 325, 326, 327, 328, 329 (topview flat emitting face 120deg)  
LDNF331TVF (**NOT** used this neon flex as it bends the wrong direction-under development)  
Polished stainless steel 10cm, 30cm, 50cm & 1m lengths

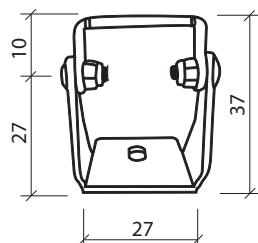

**Product code:** **LDNF300AMB**

Angle mounting bracket  
Can be used with all profiles