

LUMI360

360° Neon Flex IP65 24VDC

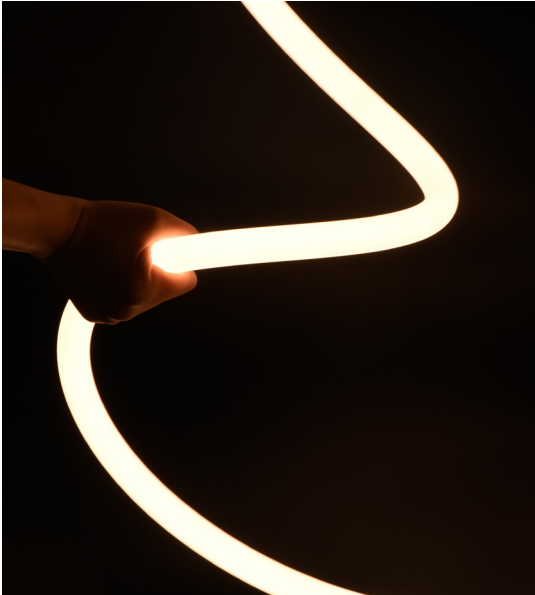

Lumi 360 neon flex features a dot free illumination with an impressive 360° viewing angle. Designed for decorative lighting for applications inside reception halls and corridors either by surface mounting or suspending.

Backed with a high level of UV protection, flame resistance and salt water resistance Lumi360 is suitable for indoor or outdoor applications.

Lumi360 can also be inserted into a clear tube for rigid non-bending applications.

Made to order lead time applies, please contact us for further information.

Features

- Ideal for creative lighting
- Available in single colour, tunable white or RGB colour changing
- Suitable for surface mounting or suspension
- CRI 90+
- Constant voltage 24VDC
- 360° viewing angle
- 5 year warranty

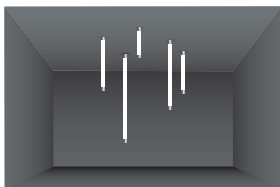

Vertical Suspended

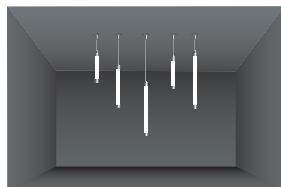

Vertical ceiling - Single

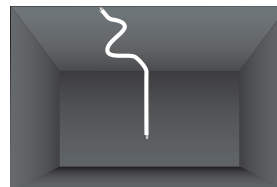

Surface mounted

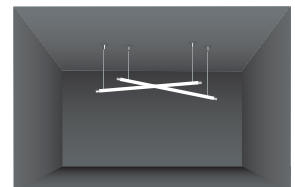

Horizontal suspended

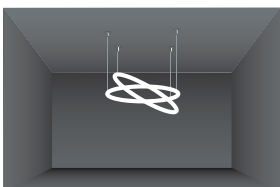

Splicing



Vertical ceiling - Double

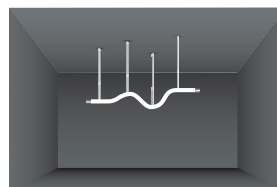

Creative

Product Information



Model No.	LD360-23D-SW <i>Static White</i>	LD360-23D-DW <i>Dual White</i>	LD360-23D-RGB <i>RGB</i>
Power	14.4W/m		
CCT/Colour	2200K~5000K		RGB
Lumen output	2200K 720 Lm/m 2400K 864 Lm/m 2700K 864 Lm/m 3000K 922 Lm/m 4000K 1008 Lm/m 5000K 1008 Lm/m	2200K 324 Lm/m 5000K 446 Lm/m 2200K + 720Lm/m 5000K	Red 86 Lm/m Green 307 Lm/m Blue 39 Lm/m RGB 418 Lm/m
Max reel size	5m		
LEDs/m	336LEDs/m	384LEDs/m	280LEDS/m
Cut length	11.9mm (variable)	10.4mm (variable)	50mm (variable)
Voltage	24VDC		
CRI (White)	CRI 90+		
IP rating	IP65		
Dimmable	Yes (PWM, DALI, 0/1-10V, Triac)		
Operating temp	-35°C ~ 50°C		
Beam angle	360°		
Bend ratio	R>110mm		
Life span	50,000Hrs		
Warranty	5 Years		

Cut Points

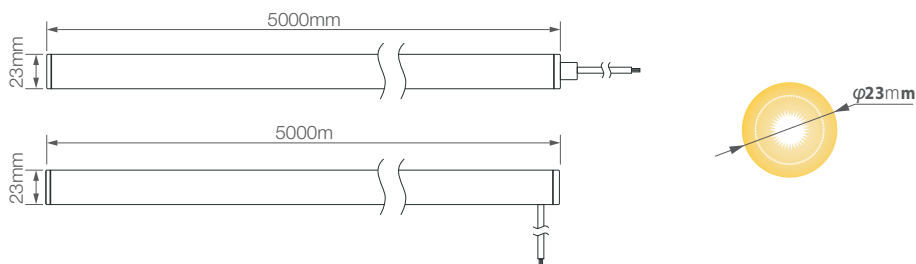

Accessories



1.Top Connection



2.Side Connection

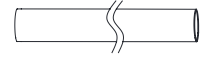

3.PC tube



4.Telescopic rod



5.Vertical Suspension

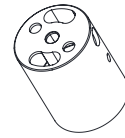

6.vertical ceiling x27

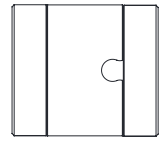

7.Splicing



8.Metal end cap

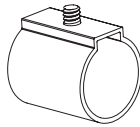

9.PC modeling accessories x2

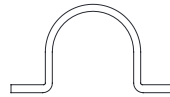

10.PC carrier



12.Sling assembly

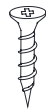

Screw

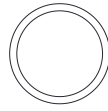

Sealing ring x5

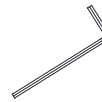

Allen wrench x1

13.Auxiliary accessories

Installation Accessory Guide

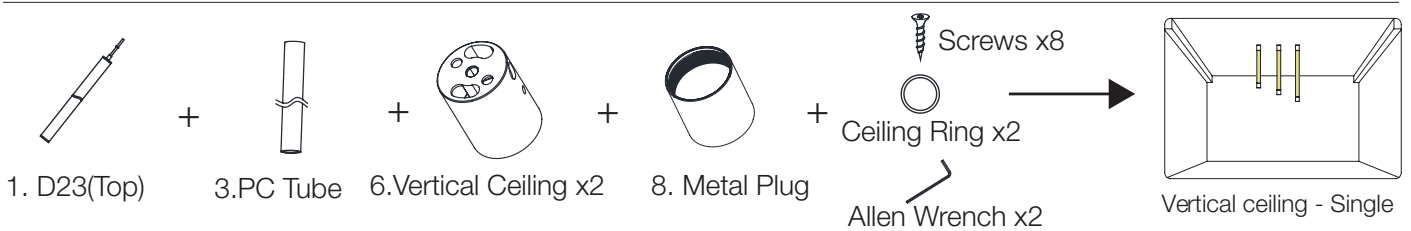
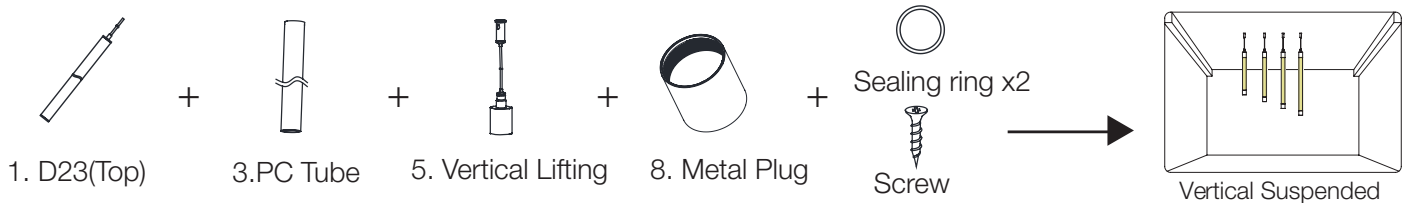

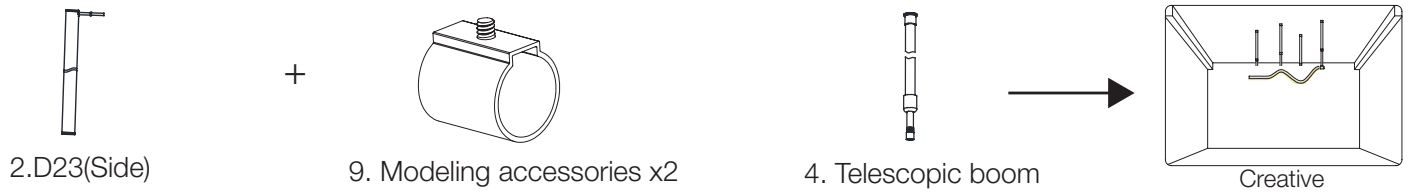
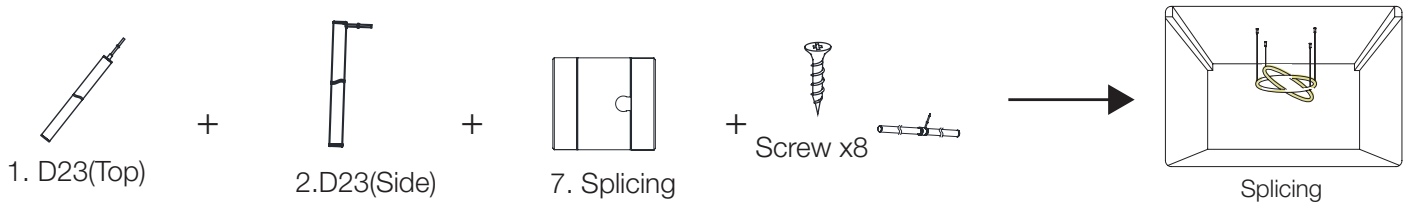
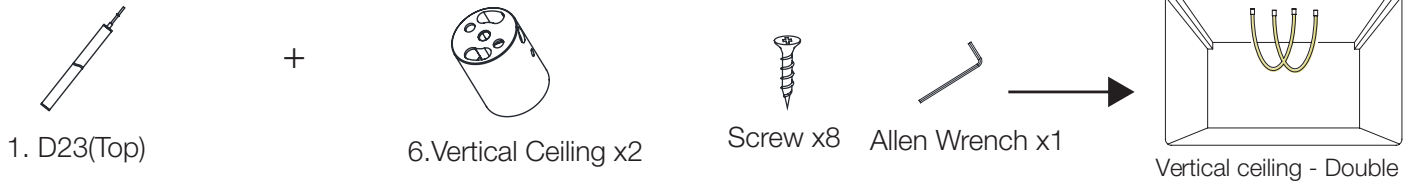

While every effort has been made to ensure the accuracy of all information provided Task Lighting can not be held responsible for any errors.
Task Lighting also reserves the right to modify/delete product details without notice.